



FFF

Manwood Road | | London | SE4 1SF

£1,595



FFF

Manwood Road |
London | SE4 1SF
£1,595

High Spec 2 bed flat in Crofton Park/Catford. Available Immediately.

Moving Inn are proud to present this beautiful modern first floor 2 bed flat located on Manwood Road in Crofton Park/Catford. The property boasts modern open plan kitchen with integrated appliances, spacious lounge, two bedrooms with fitted wardrobes and a modern family bathroom.

The property is ideally located for shops, restaurants and amenities of Catford and it further benefits from great transport links with the Catford and Catford Bridge stations being only 10 minutes walk away providing a quick and easy access to Central London. It is also located within 100 metres from Ladywell Fields.

EPC rating: C
Council Tax: Lewisham, Band C

Notice: All photographs, measurements and furniture in this advert are provided for guidance only

- 2 cosy bedrooms
- Spacious reception room
- Close to local amenities
- Perfect for professionals
- 1 modern bathroom
- 484 sq ft living space
- Easy access to transport
- Viewing highly recommended

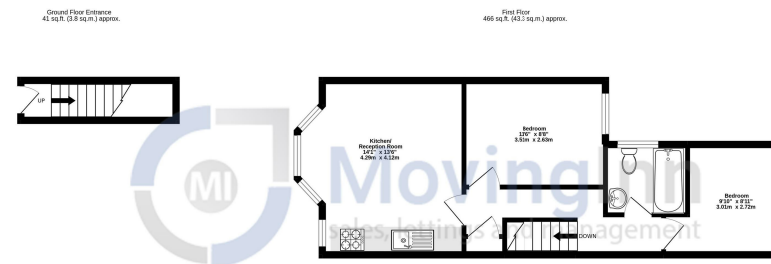

Energy Efficiency Rating		
	Current	Potential
Very energy efficient - lower running costs		
(92 plus) A		
(81-91) B		
(69-80) C	79	79
(55-68) D		
(39-54) E		
(21-38) F		
(1-20) G		
Not energy efficient - higher running costs		
England & Wales	EU Directive 2002/91/EC	

Council Tax Band C
EPC Rating C

467 Norwood Road
West Norwood
London
SE27 9DJ
02087610830
dean@movinginn.co.uk
www.movinginn.co.uk